

Ek 3.1.

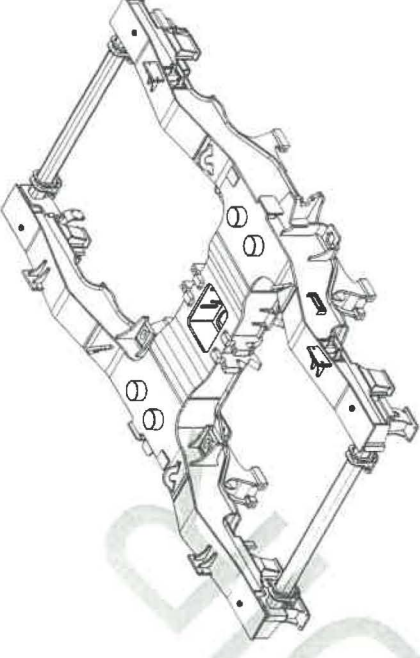

Isometric view

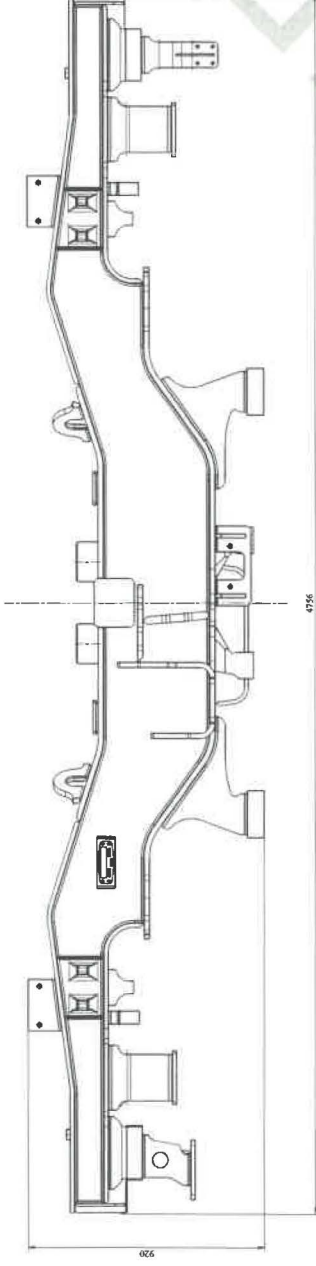
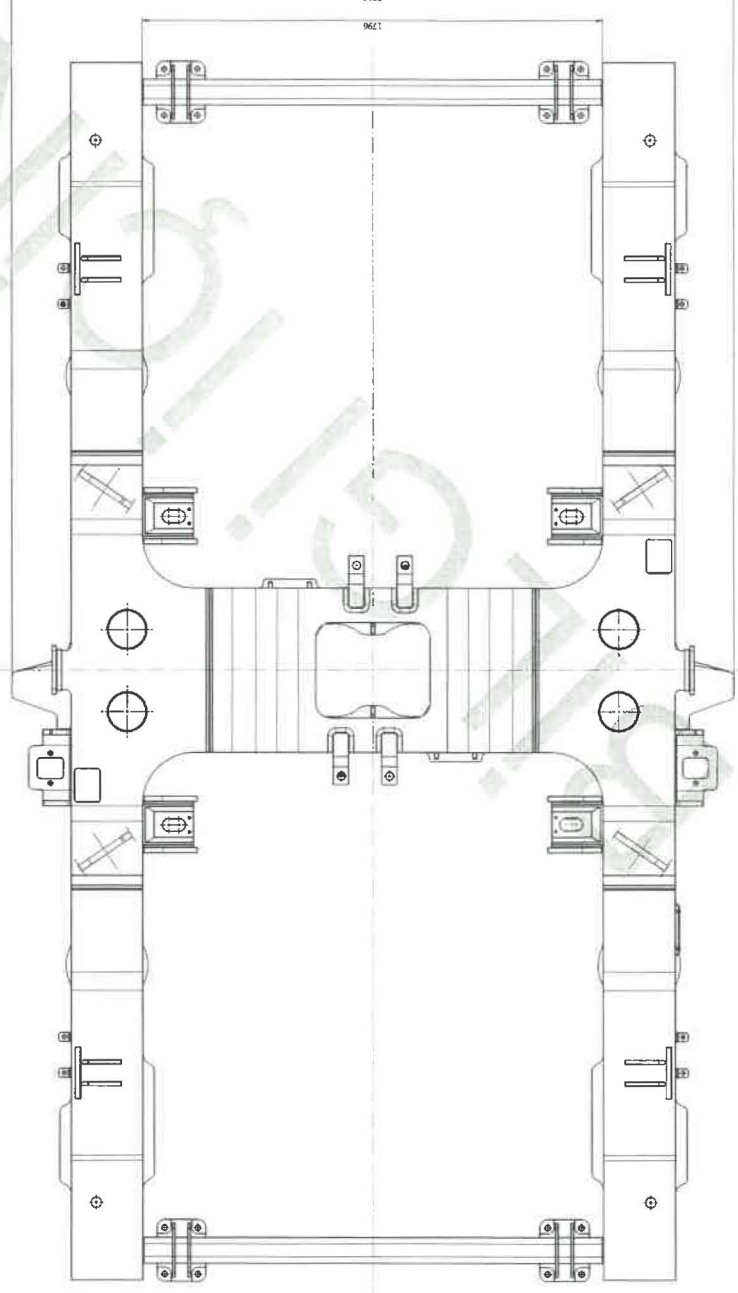

BOGIE FRAME
TOPLAM AĞIRLIK : ~2764 KG

Ek 3.2

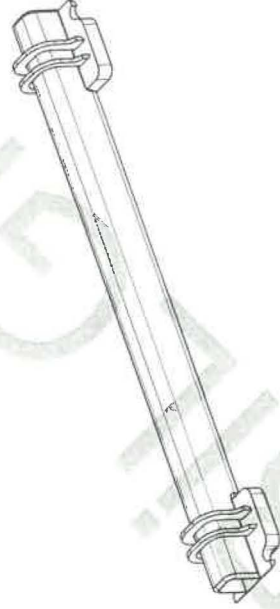
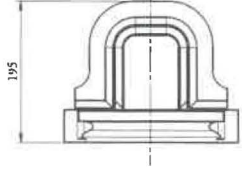
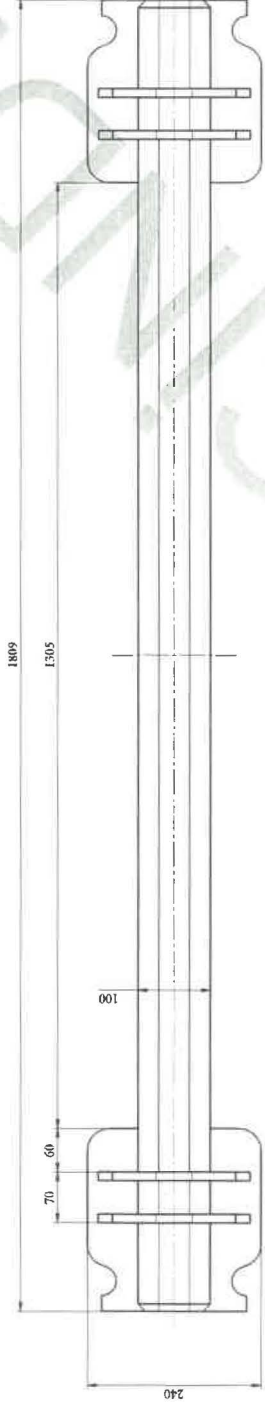
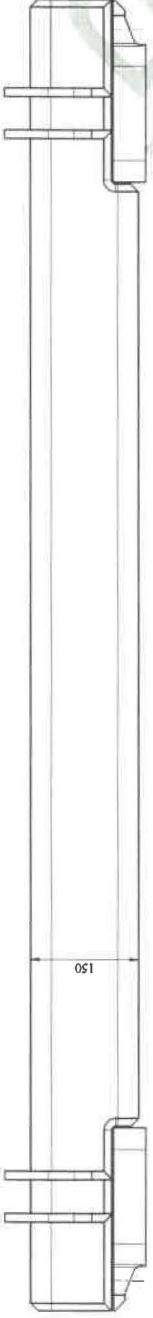

END BEAM
TOPLAM AĞIRLIK : ~68 KG

Ek 3.3

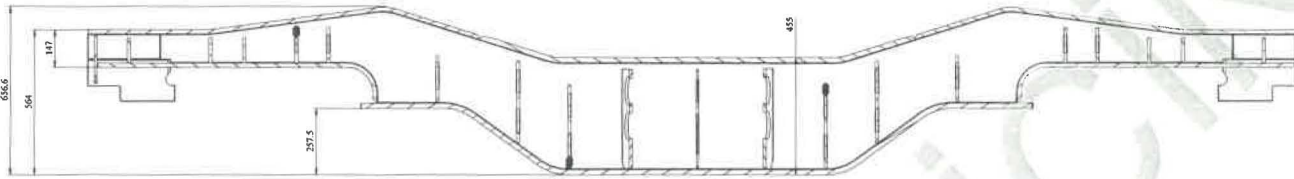
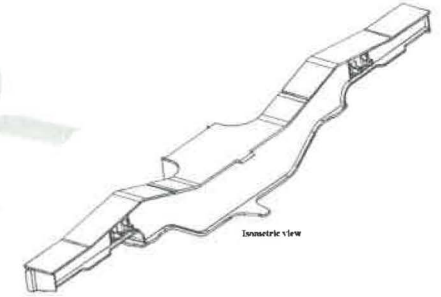
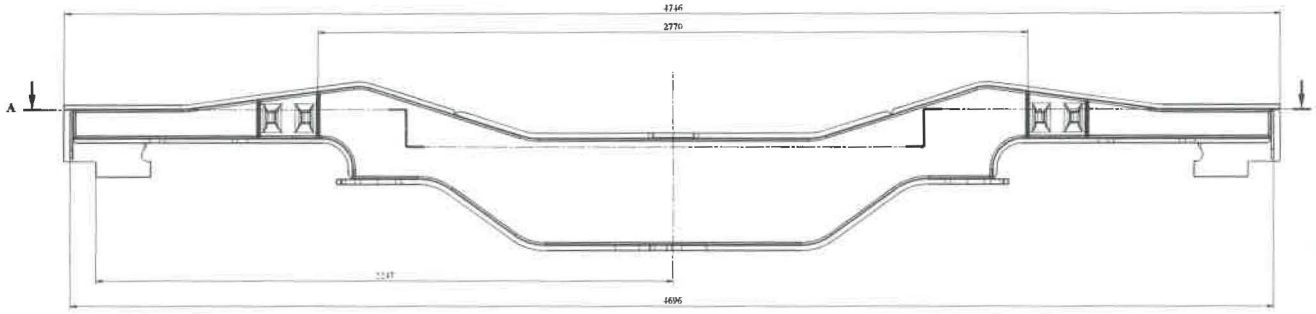

Section view B-B
Scale: 1:10

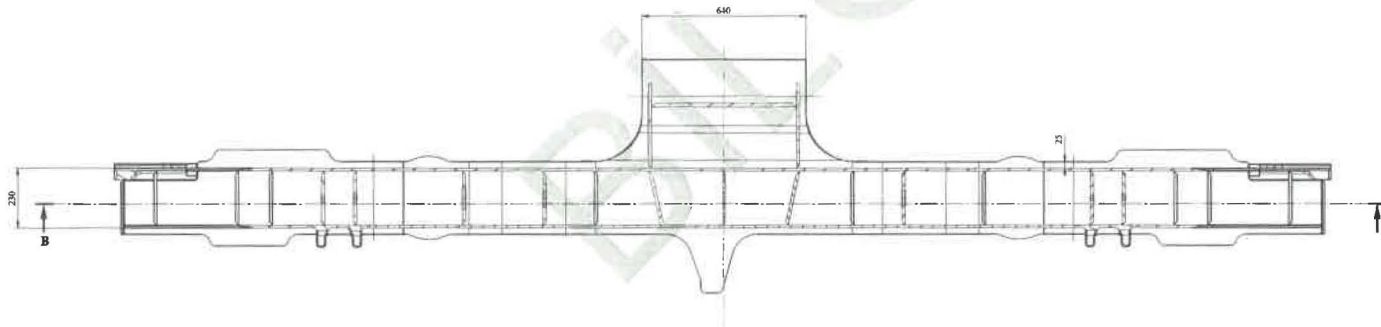

Section view A-A

YAN KİRİŞ
TOPLAM AĞIRLIK : ~792 KG

Ek 34.

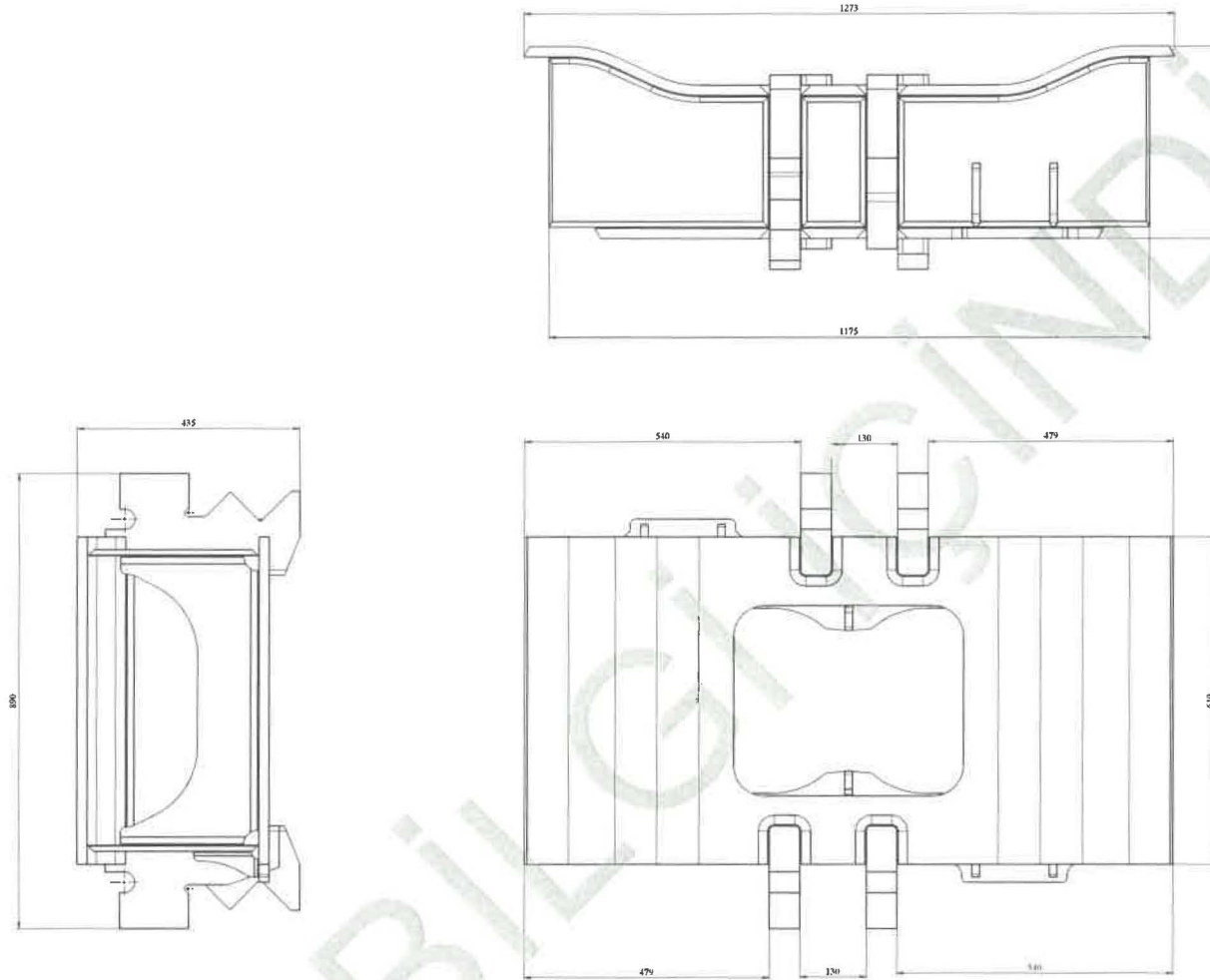

TRANSOM
TOPLAM AĞIRLIK : ~403 KG

