

8230584

2.00 +.05  
-.00  
(OPTIONAL)

50.8

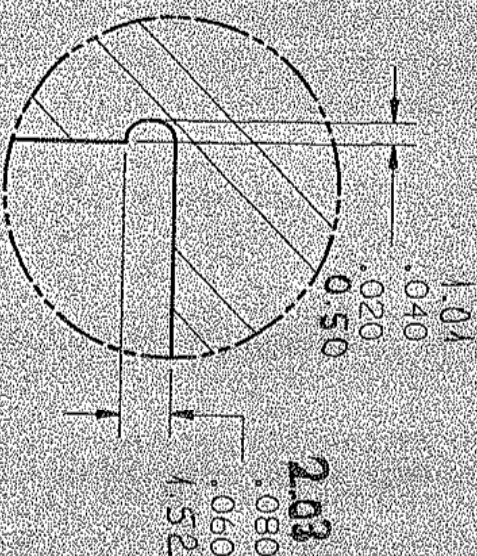

VIEW A  
OPTIONAL UNDERCUT IN HEAD

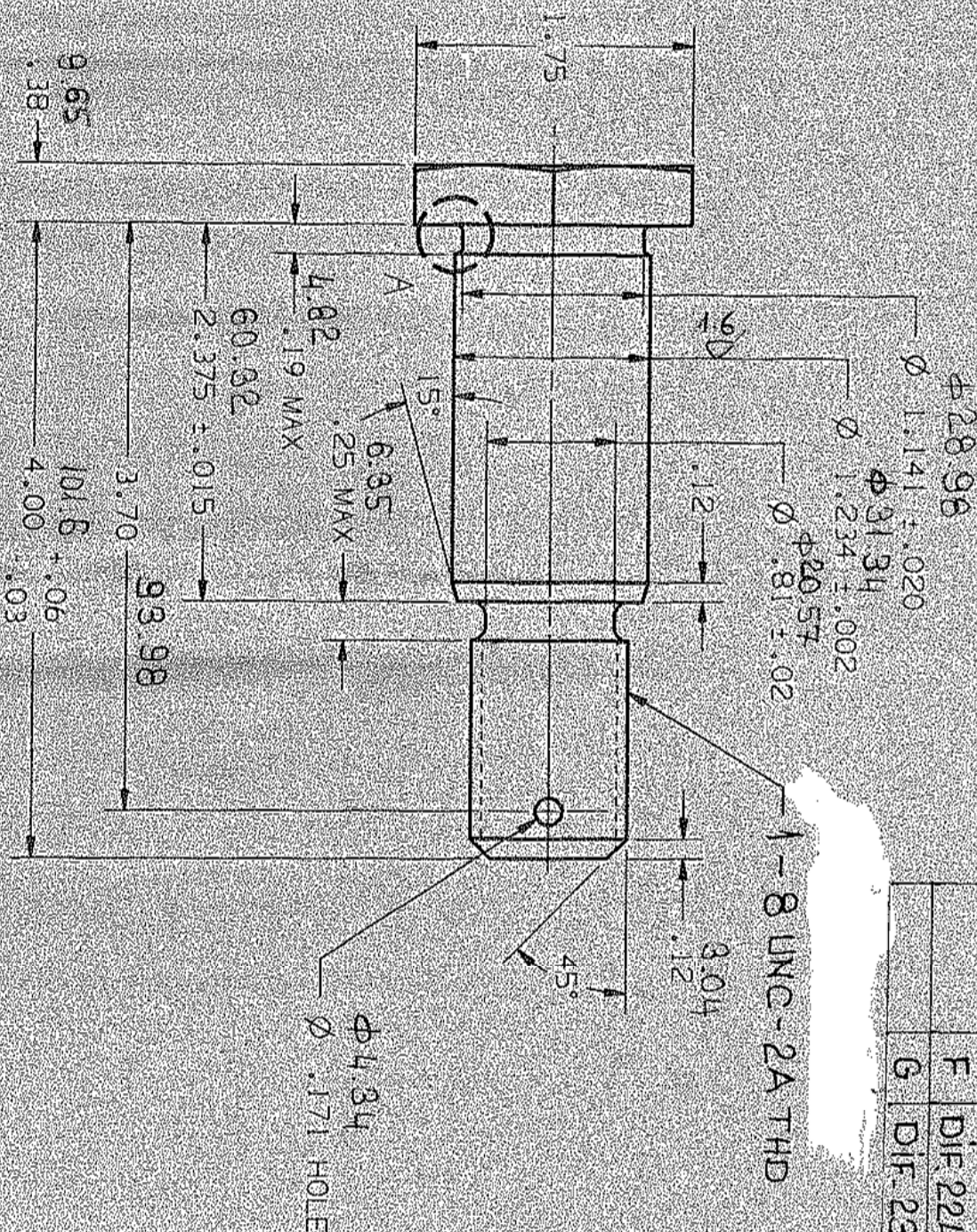

Ø 4.34  
Ø .171 HOLE

Set HRC 54-58 HRC  
Sementite Damlığı 2,5-3 mm  
(150HRC)

REV	REV NO.	DATE	BY	APVD
E1	D66524			
E2				
F	DIF. 2243'e göre dis M24 oldu. 02.03.2006			
G	DIF. 2389'a göre dis 1" oldu. 30.04.2007			

030C03 LDD QHW Xm

Materne C1040

TŞ 230.010 (Dövrne)  
TŞ 230 981 (Girleme)

Ver No	Sıra No
	5506

TOLERANCES ON ALL DIMENSIONS NOT SPECIFIED ON THE DRAWING TO BE IN ACCORDANCE WITH A.1, 2400. BREAK ALL SHARP CORNERS UNLESS OTHERWISE SPECIFIED. ALL DIMENSIONS ARE IN INCHES UNLESS OTHERWISE SPECIFIED.		APERTURE CARD ONLY	
THIRD ANGLE PROJECTION			
UNLESS OTHERWISE SPECIFIED, THIS DOCUMENT IS IN ACCORDANCE WITH ASME Y14.5M - 1994 AS AMENDED BY THE GEOMETRIC DIMENSIONS AND TOLERANCING ADDENDUM - 2001. ALL GEOMETRIC TOLERANCES AND RELATED TOLERANCING APPLY. RULE #1 (PERFECT FORM AT MMC) DOES NOT APPLY WHEN A RELATIONSHIP BETWEEN FEATURES IS ESTABLISHED BY ORIENTATION OR LOCATION TOLERANCES. SEPARATE POSITION CALCULATIONS MAY BE GAUGED SEPARATELY REGARDLESS OF DATUM REFERENCES.			
COMPUTER GRAPHICS CHANGE ONLY		GEOMETRIC TOLERANCING SYMBOLS	
APPROXIMATE WEIGHT (LBS) 1.4			
Z PLAT		Z TOTAL RUNOUT	
Z ANGULAR		Z TRUE POSITION	
Z CONCENTRIC		Z PERPENDICULAR	
Z MAXIMUM MATERIAL CONDITION (MMC)		Z PROFILE OF A LINE	
Z LEAST MATERIAL CONDITION (LMC)		Z PROFILE OF A SURFACE	
Z PROJECTED TOLERANCE ZONE		Z DATUM IDENTIFICATION	
Z REGARDLESS OF FEATURE SIZE (RFS)		Z BASIC	
Z DATUM TARGET		Z DATUM	
MATERIAL		DATE	
EWS 86		190055	
STEEL P.I.N		190055	
B. M. PETERSON		190055	
SMUTNY		190055	
S		190055	
WELD		280055	
JBS		280055	
NCT		300055	
RWR		300055	
PROL		300055	
FIRST USED ON		PART NO.	
SERVICE		8230584	
8101916		SHEET 1 OF 1	
UG SOLID			

GM ELECTROMOTIVE  
LA GRANGE, IL 60525, U.S.A.  
LONDON, ONT. N6A 4N5, CANADA

PIN

8230584