

# 8040320

PERMISSIBLE VARIATION ON COMMON FRACTION DIMENSIONS TO MACHINED SURFACES TO BE  $\pm 0.010$  UNLESS OTHERWISE SPECIFIED. FABRICATION TOLERANCE.

BREAK ALL SHARP CORNERS UNLESS OTHERWISE SPECIFIED.

COUNTERSINK ALL TAPPED HOLES  $118^\circ$  X ONE THRD DEEP.

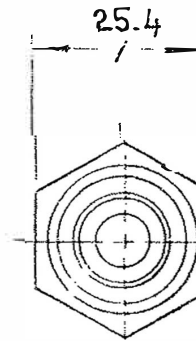
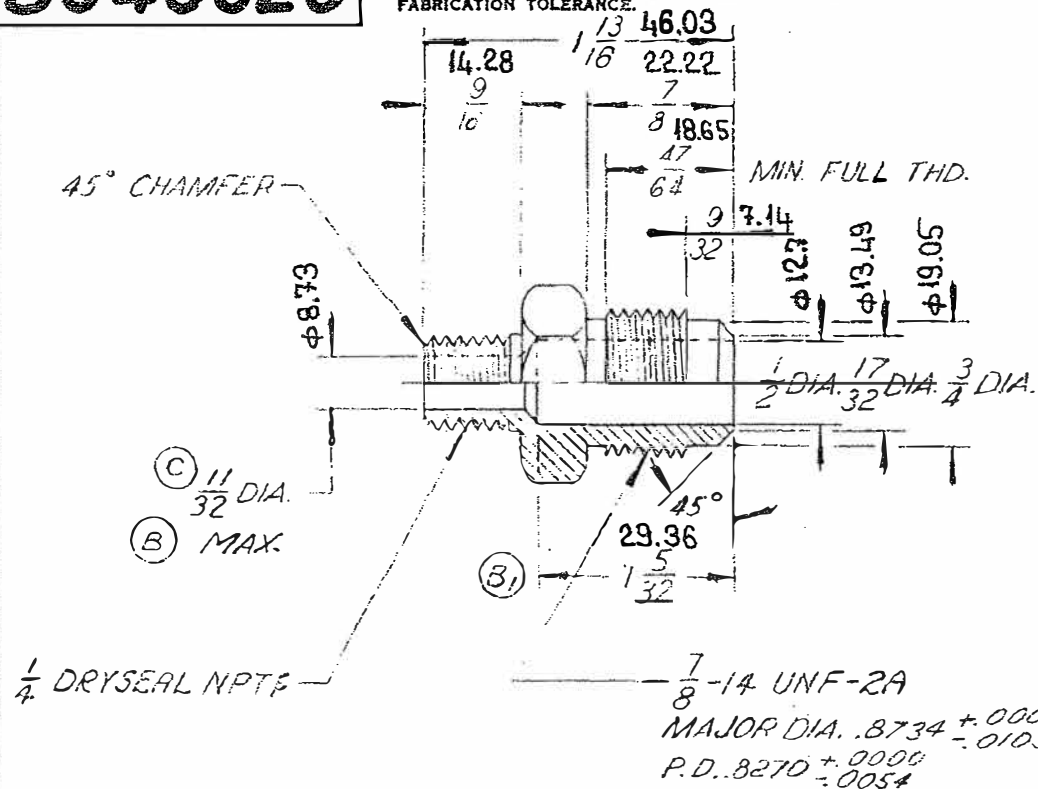

## STANDARD PART

Yer No	Sira No
	1 3498

							MATERIAL		NAME OF PART		PART NO.	IT. NO.
							BRASS		ELECTRO-MOTIVE DIVISION		GENERAL MOTORS CORPORATION	
									LA GRANGE, ILLINOIS, U.S.A.			
									CONN-5/8T-1/4PT			
									DATE OF PRINT		PART NO.	
											8040320	

R. F. C. NO.	REV. LET.	REVISION	DATE	BY	CK.	APV'D.	NO. REQUIRED PER ASSEMBLY	MATERIAL	DR.	DATE
B12203	D	EASR REM'D	18-MY-81	GL	F.S.	R.B.				
F.F.F.91	C	WAS 5/16 DIA.	7-10-56	CLSEN	R.	A.				
23275	B	MAX. ADDED B1-DIM. ADDED	4-9-51	N.K.	J.R.	Rev.				
M-6324	A	STD. PT. & APP. OF SOURCE NOTES ADDED	8-7-51	RICC.	J.C.					
							CH. CK.	SUP.		
							WELD.	CH. DR.		
							ENGR.			