

ENGINEERING STANDARDS SECTION

GENERAL MOTORS CORPORATION - G. M. TECHNICAL CENTER - WARREN, MICHIGAN

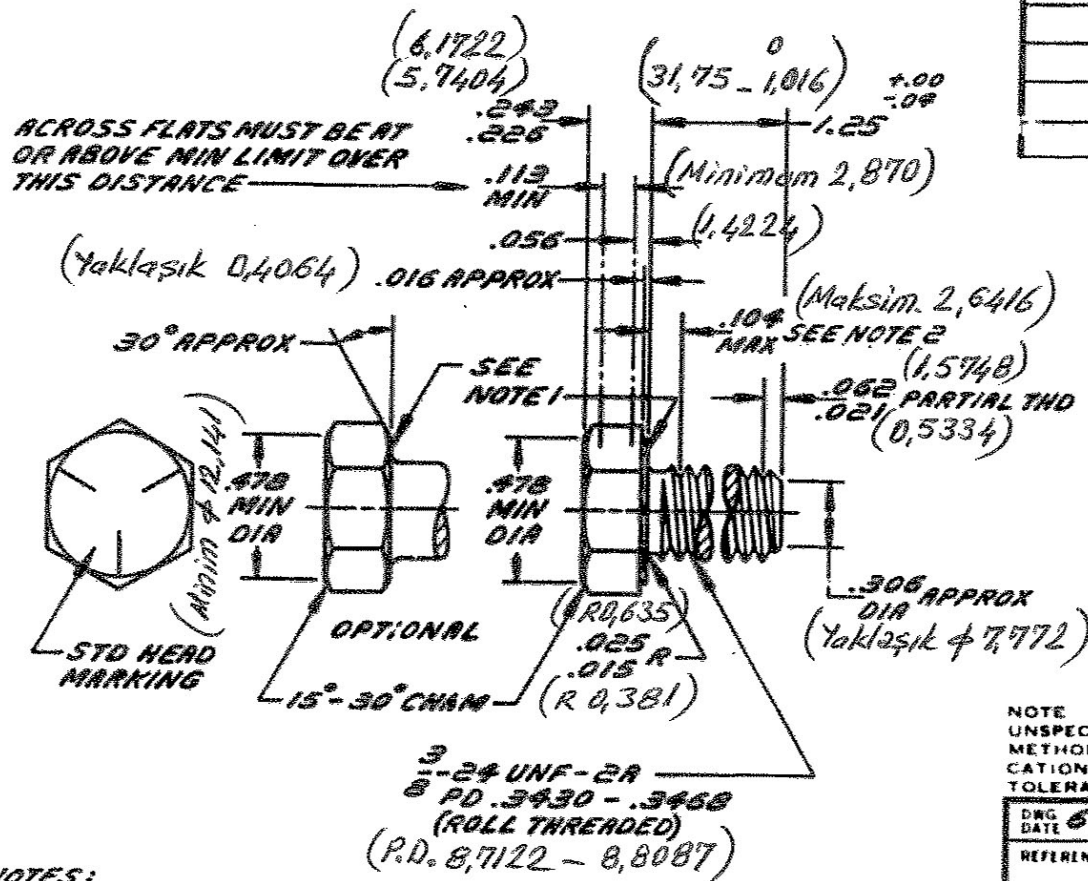

NOTES:

1. AXIS OF HEAD MUST BE CONCENTRIC WITH AXIS OF BOLT WITHIN .034 TIR. BEARING FACE SHALL BE FLAT WITH DIA OF .506 - .562 AND SQUARE WITH BOLT AXIS WITHIN 2° (REF .018 MAX TOTAL RUNOUT).
2. DIA OF UNTHREADED SHANK TO BE .343 - .375.

DESCRIPTION	3-24x1/4 CL 2A
FINISH	PLAIN

NO.	181370				
DATE	SYM	REVISION RECORD	AUTHORITY	DR	CHK
4-11-79	E	REDRAWN & REVISED		CC	

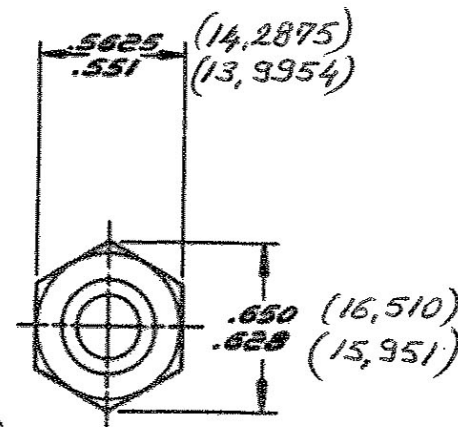

NOTE
UNSPECIFIED DETAIL WITH RESPECT TO DIMENSIONS. MATERIAL METHODS OF TEST, ETC. MUST CONFORM TO GENERAL SPECIFICATIONS PUBLISHED IN G. M. ENGINEERING STANDARDS. TOLERANCE PLUS OR MINUS .010 UNLESS OTHERWISE SPECIFIED.

DWG DATE	6-15-48	SCALE	DR	ES
REFERENCE			CHK	
			APPD	
MATERIAL SPEC	EMS 82 GM 280-M STEEL			
NAME	BOLT-HEXAGON			
PART NO	181370			