

# ENGINEERING STANDARDS SECTION

GENERAL MOTORS CORPORATION - G. M. TECHNICAL CENTER - WARREN, MICHIGAN

$$T_1 \text{ MINUS } T_2 = .0190 - .0095$$

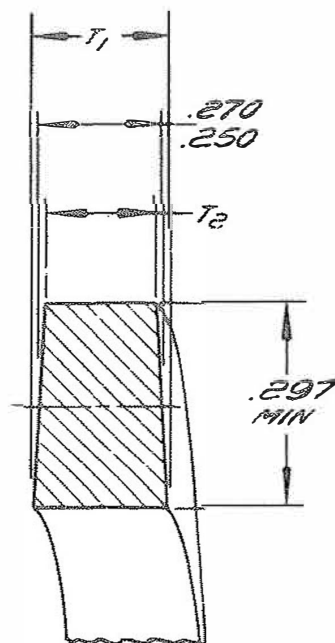

ENLARGED SECTION

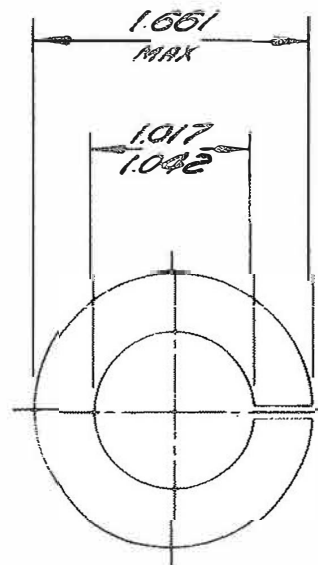

GAP AND RELATIONSHIP OF ENDS  
TO BE SUCH AS TO PREVENT  
WASHERS TANGLING AND INSURE  
THAT WASHERS WILL COMPRESS  
FLAT

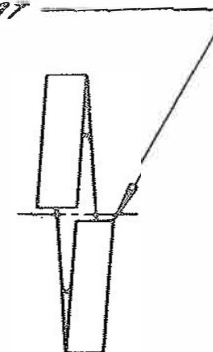

Ver No 1718 / 162  
Sira No

## NOTE :

UNSPECIFIED DETAIL WITH RESPECT TO DIMENSIONS MATERIAL  
METHODS OF TEST, ETC MUST CONFORM TO GENERAL SPECIFICATIONS  
PUBLISHED IN GM ENGINEERING STANDARDS  
TOLERANCE PLUS OR MINUS .010 UNLESS OTHERWISE SPECIFIED

DWG DATE 2-26-48	SCALE	DR RLS
REFERENCE	CK.	APPR.
MATERIAL SPEC. STEEL - SEE NOTE ROCKWELL C45-53		
NAME WASHER - REGULAR HELICAL SPRING LOCK		
DESCRIPTION 1" (1.000)		PART NO. 121326
FINISH PLAIN		