

# ENGINEERING STANDARDS SECTION

GENERAL MOTORS CORPORATION - G. M. TECHNICAL CENTER - WARREN, MICHIGAN

$$T_1 \text{ MINUS } T_2 = .0090 - .0045$$

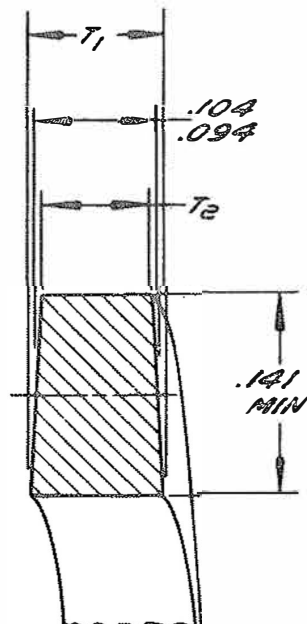

ENLARGED SECTION

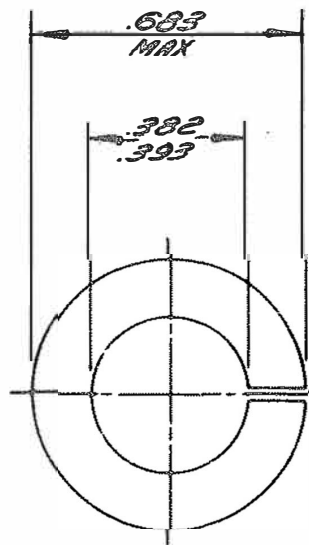

GAP AND RELATIONSHIP OF ENDS  
TO BE SUCH AS TO PREVENT  
WASHERS TANGLING AND INSURE  
THAT WASHERS WILL COMPRESS  
FLAT

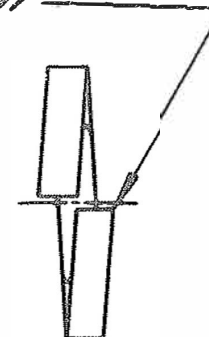

## NOTE:

UNSPECIFIED DETAIL WITH RESPECT TO DIMENSIONS, MATERIAL, METHODS OF TEST, ETC., MUST CONFORM TO GENERAL SPECIFICATIONS PUBLISHED IN GM ENGINEERING STANDARDS. TOLERANCE PLUS OR MINUS .010 UNLESS OTHERWISE SPECIFIED.

DWG. DATE	5-11-26	SCALE	DR. MD
REFERENCE		CHK.	
		APPR.	
MATERIAL SPEC.			
STEEL - SEE NOTE ROCKWELL C45-53			
NAME			
WASHER - REGULAR HELICAL SPRING LOCK			
PART NO.			
103321			

Ver No	5178 No
1718/15	

DESCRIPTION	PLAIN
FINISH	