

ENGINEERING STANDARDS SECTION

GENERAL MOTORS CORPORATION - G. M. TECHNICAL CENTER - WARREN, MICHIGAN

$$T_1 \text{ MINUS } T_2 = .0080 - .0040$$

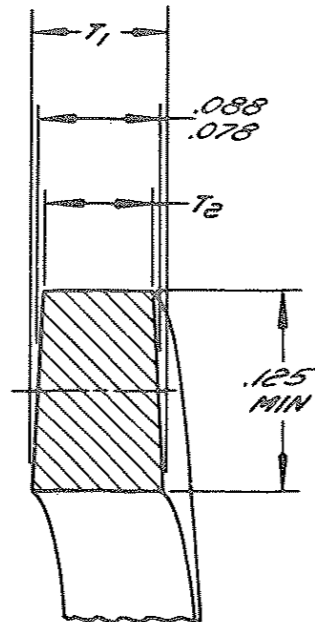

ENLARGED SECTION

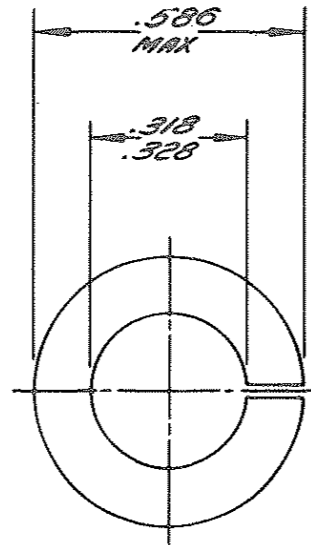

GAP AND RELATIONSHIP OF ENDS
TO BE SUCH AS TO PREVENT
WASHERS TANGLING AND INSURE
THAT WASHERS WILL COMPRESS
FLAT

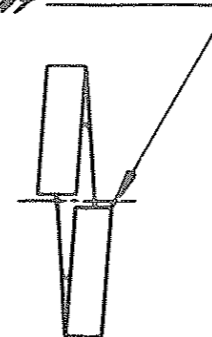

NOTE:

UNSPECIFIED DETAIL WITH RESPECT TO DIMENSIONS. MATERIAL METHODS OF TEST, ETC., MUST CONFORM TO GENERAL SPECIFICATIONS PUBLISHED IN GM ENGINEERING STANDARDS. TOLERANCE PLUS OR MINUS .010 UNLESS OTHERWISE SPECIFIED.

DWG. 9-6-44 DATE	SCALE	DR. BWJ
REFERENCE	CK. <i>✓</i>	APPR.
MATERIAL SPEC. STEEL - SEE NOTE ROCKWELL C45-53		
NAME WASHER - REGULAR HELICAL SPRING LOCK		
PART NO. 103320		

Year No	Size No
1718	14

DESCRIPTION 5/16
FINISH PLAIN